

SCHNIEPER ARCHITEKTEN

15. APRIL 2022

«IDEEN-SKIZZE» – OFFENER PROJKETWETTBEWERB LUZERNER THEATER



15. APRIL 2022

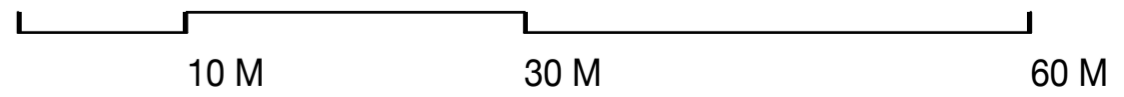

# RAUMPROGRAMM (VERGLEICH: NETTOFLÄCHEN IDEENSKIZZE – RAUMPROGRAMM WETTBEWERB)

**PUBLIKUMSRÄUME**  
 UG 272 M2 + PARTERRE 475 M2 + 1. OG 964 M2 +  
 2. OG 669 M2 + 3. OG 952 M2 + 4. OG 12 M2 +  
 ATTIKA 104 M2 = 3'448 M2  
 3'448 M2 - 12% WÄNDE = **3'034 M2 NETTO**  
**RAUMPROGRAMM\* 998 M2 NETTO**

**BÜHNEN - UND VERANSTALTUNGSRÄUME**  
 UG 334 M2 + PARTERRE 410 M2 + 1. OG 805 M2 +  
 3. OG 330 M2 = 1'879 M2  
 1'879 M2 - 12% WÄNDE = **1'653 M2 NETTO**  
**RAUMPROGRAMM\* 1'696 M2 NETTO**

**ORCHESTERRÄUME**  
 UG 160 M2 + 1. OG 100 M2 + 4. OG 95 M2 = 355 M2  
 355 M2 - 12% WÄNDE = **312 M2 NETTO**  
**RAUMPROGRAMM\* 300 M2 NETTO**

**STUDIEN - UND PROBENRÄUME**  
 3. OG 95 M2 + ATTIKA 95 M2 = 190 M2  
 190 M2 - 12% WÄNDE = **167 M2 NETTO**  
**RAUMPROGRAMM\* 136 M2 NETTO**

**KÜNSTLERGARDEROBEN**  
 1. OG 140 M2 + 2. OG 140 M2 = 280 M2  
 280 M2 - 12% WÄNDE = **246 M2 NETTO**  
**RAUMPROGRAMM\* 270 M2 NETTO**

**GASTRONOMIE**  
 PARTERRE 145 M2 + ATTIKA 700 M2 = 845 M2  
 845 M2 - 12% WÄNDE = **744 M2 NETTO**  
**RAUMPROGRAMM\* 500 M2 NETTO**

**PERSONALRÄUME**  
 3. OG 95 M2 + 4. OG 95 M2 + ATTIKA 95 M2 = 285 M2  
 285 M2 - 12% WÄNDE = **251 M2 NETTO**  
**RAUMPROGRAMM\* 257 M2 NETTO**

**FACHBEREICHE VERANSTALTUNGSBETRIEB**  
 4. OG 830 M2  
 830 M2 - 12% WÄNDE = **730 M2 NETTO**  
**RAUMPROGRAMM\* 772 M2 NETTO**

**BETRIEBS-, GEBÄUDE- & SICHERHEITSTECHNIK**  
 UG 779 M2 + PARTERRE 104 M2 + 1. OG 34 M2 +  
 2. OG 34 M2 + 3. OG 34 M2 + 4. OG 60 M2 +  
 ATTIKA 275 M2 = 1'320 M2  
 1'320 M2 - 12% WÄNDE = **1'161 M2 NETTO**  
**RAUMPROGRAMM\* 1'155 M2 NETTO**

# FLÄCHEN (INKL. WÄNDE 12%)

**UNTERGESCHOSS**  
 L 50.90 M1 x B 33.50 M1 = 1'705 M2

**PARTERRE**  
 L 50.90 M1 x B 33.50 M1 = 1'705 M2

**1. OBERGESCHOSS**  
 L 63.40 M1 x B 38.50 M1 = 2'441 M2

**2. OBERGESCHOSS**  
 L 63.40 M1 x B 38.50 M1 = 2'441 M2

**3. OBERGESCHOSS**  
 L 63.40 M1 x B 38.50 M1 = 2'441 M2

**4. OBERGESCHOSS**  
 L 63.40 M1 x B 38.50 M1 = 2'441 M2

**ATTIKA**  
 L 63.40 M1 x B 38.50 M1 = 2'441 M2

**TOTAL** = **15'615 M2**

# VOLUMEN (OHNE ZUSCHLÄGE)

**UNTERGESCHOSS**  
 L 50.90 M1 x B 33.50 M1 x H 5.75 M1 = 9'805 M3

**PARTERRE**  
 L 50.90 M1 x B 33.50 M1 x H 7.00 M1 = 11'936 M3

**1. OBERGESCHOSS**  
 L 63.40 M1 x B 38.50 M1 x H 3.50 M1 = 8'543 M3

**2. OBERGESCHOSS**  
 L 63.40 M1 x B 38.50 M1 x H 3.50 M1 = 8'543 M3

**3. OBERGESCHOSS**  
 L 63.40 M1 x B 38.50 M1 x H 3.50 M1 = 8'543 M3

**4. OBERGESCHOSS**  
 L 63.40 M1 x B 38.50 M1 x H 3.50 M1 = 8'543 M3

**ATTIKA**  
 L 53.40 M1 x B 38.50 M1 x H 4.00 M1 = 8'224 M3

**DACHBEREICH SCHNÜRBODEN**  
 L 14.00 M1 x B 21.00 M1 x H 6.00 M1 = 1'764 M3

**TOTAL** = **65'901 M3**

\*RAUMPROGRAMM OFFENER PROJEKTWETTBEWERB STADT LUZERN,  
 NEUES LUZERNER THEATER, UNTERLAGE U3 A, 28. 11. 2021, Ver.1.0

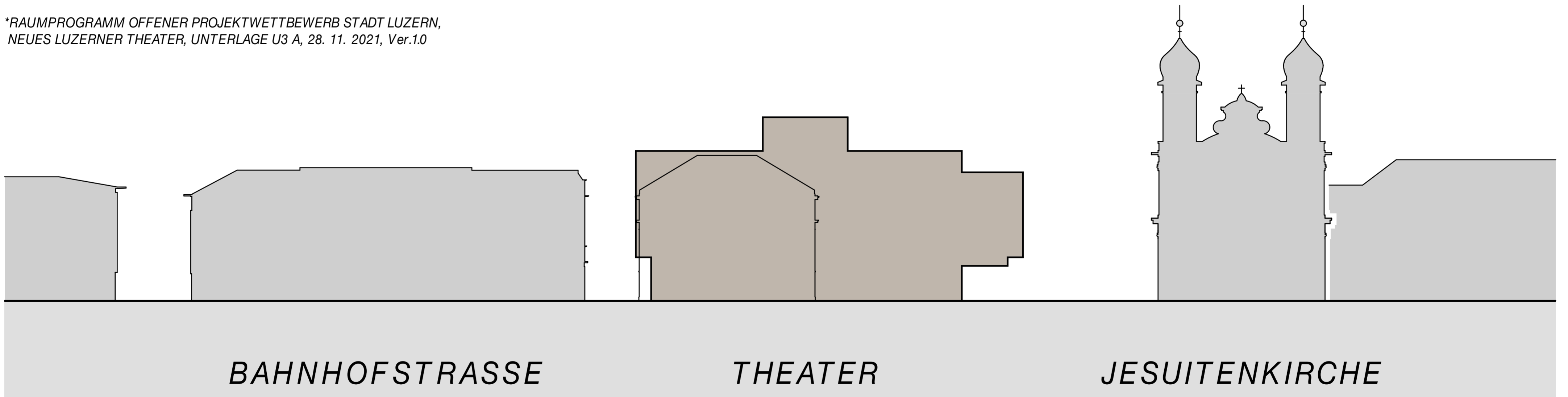

SCHNIEPER ARCHITEKTEN

15. APRIL 2022

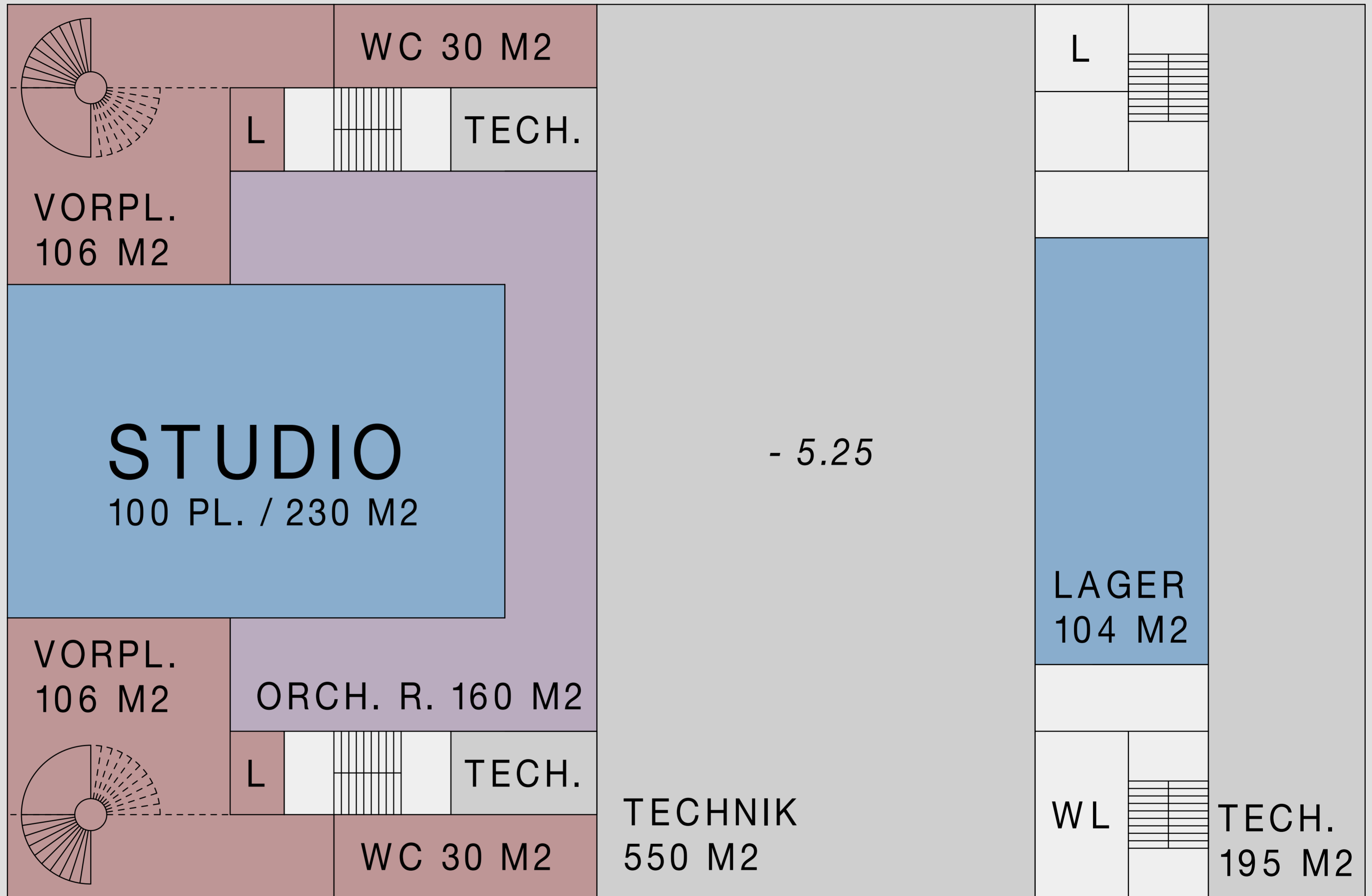



THEATER-  
PLATZ

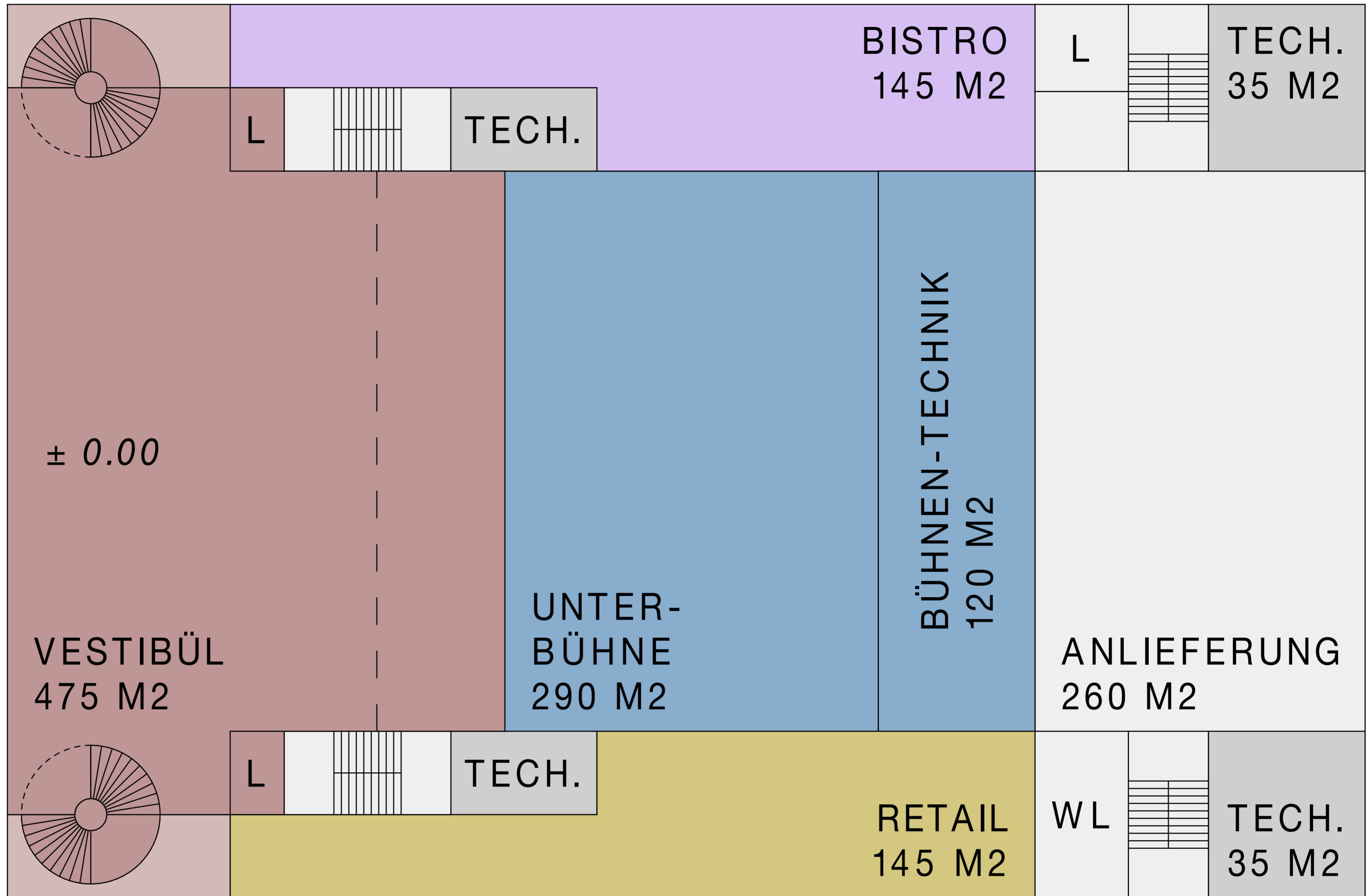

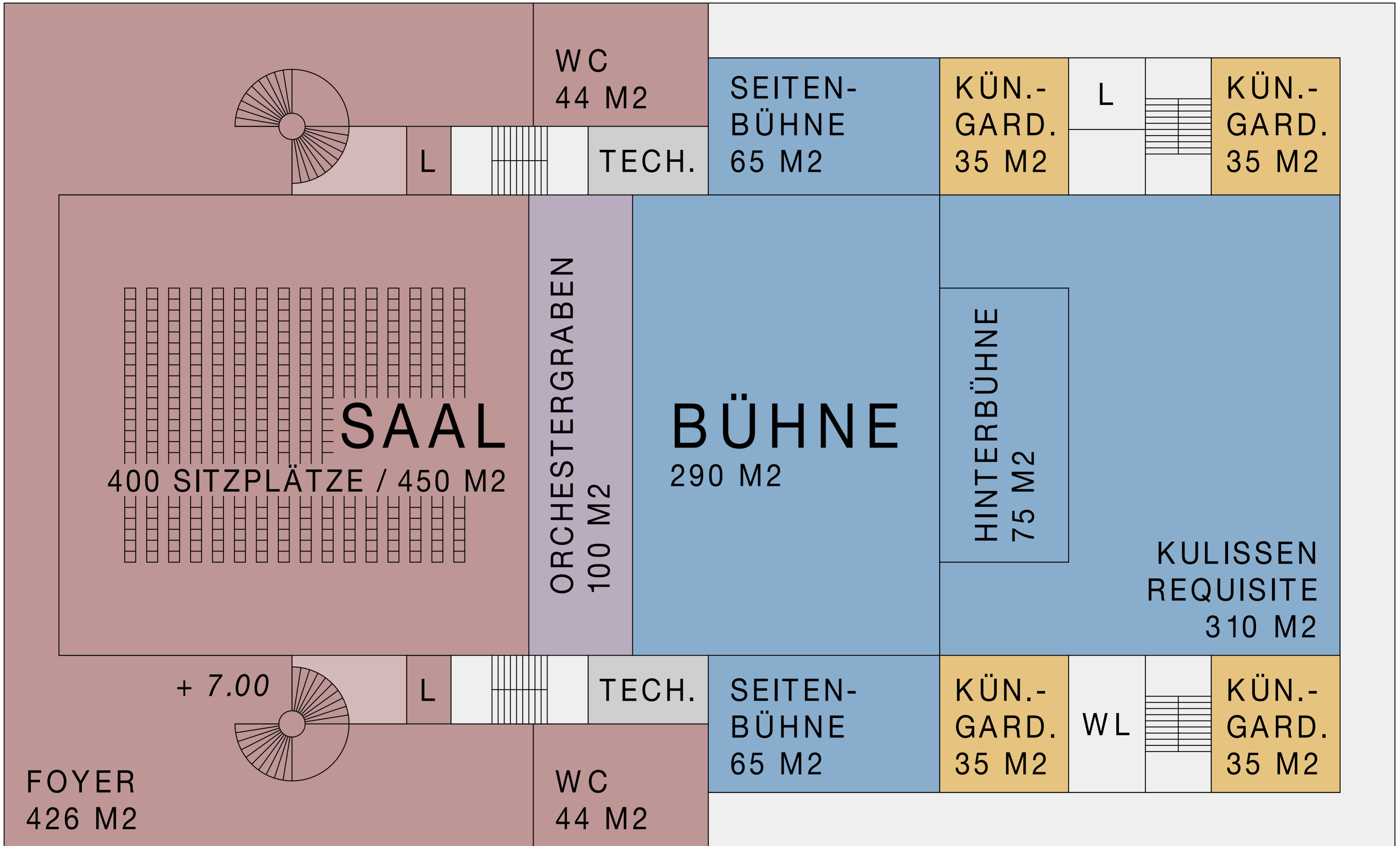

SCHNIEPER ARCHITEKTEN

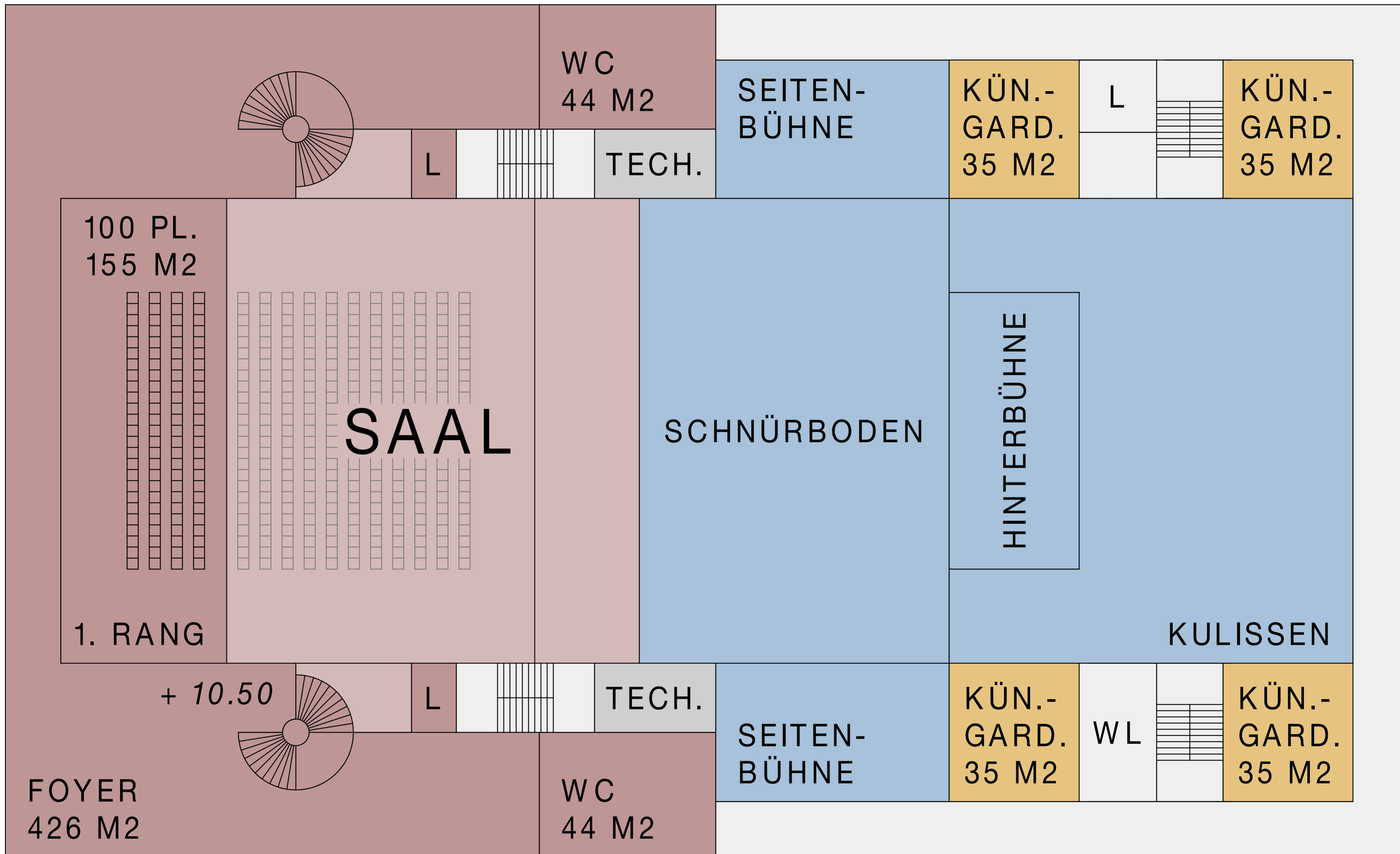

SCHNIEPER ARCHITEKTEN

15. APRIL 2022

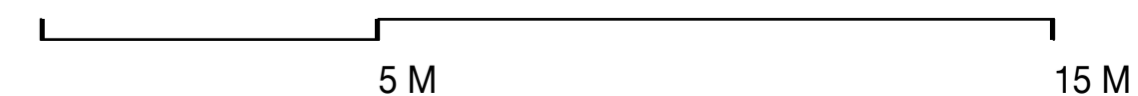

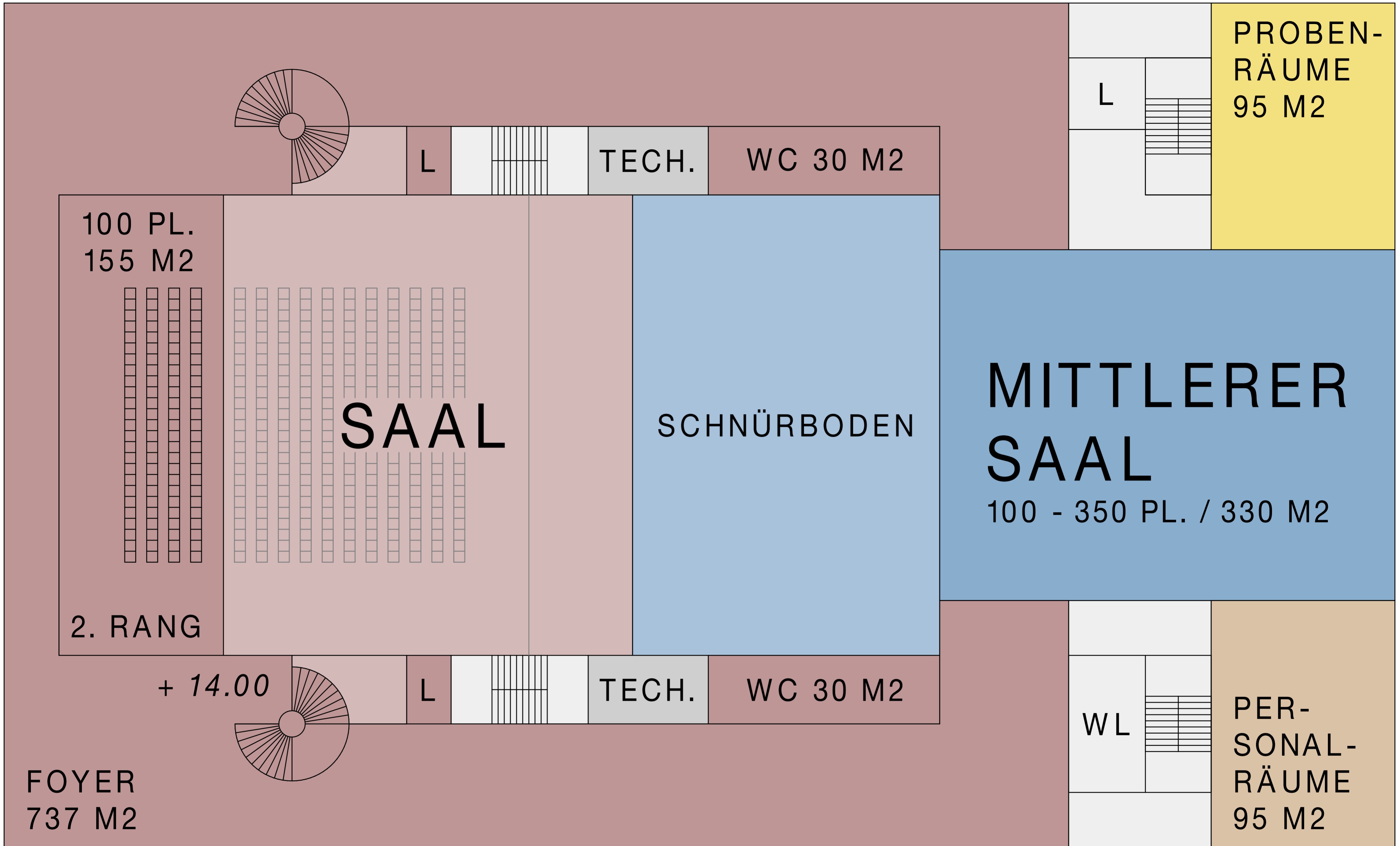

SCHNIEPER ARCHITEKTEN



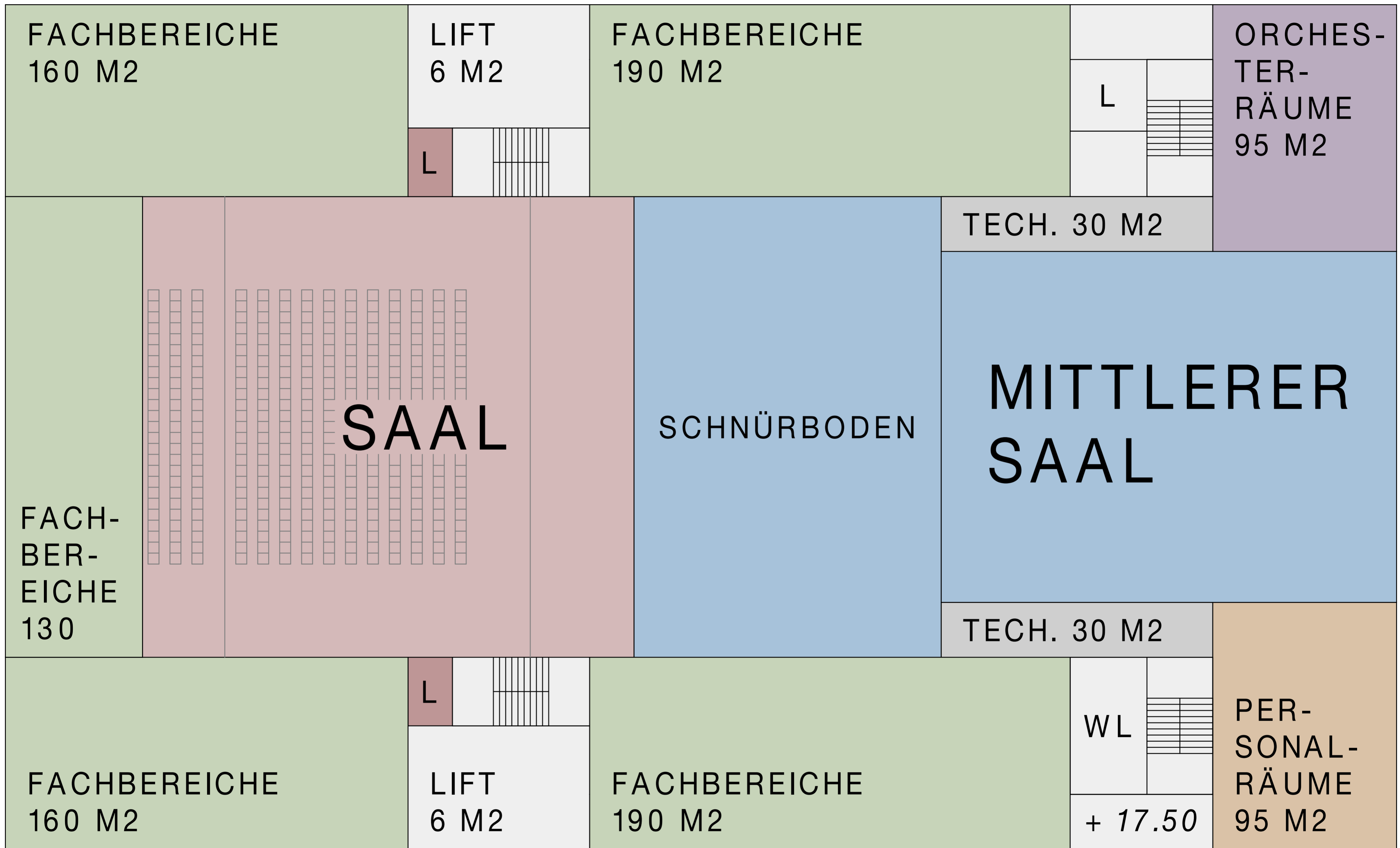

SCHNIEPER ARCHITEKTEN

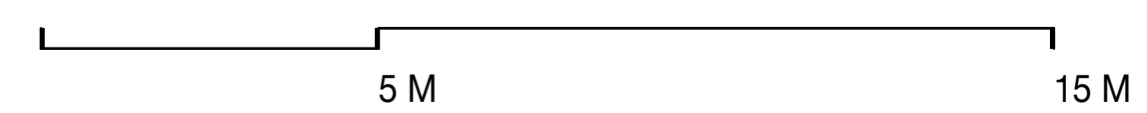

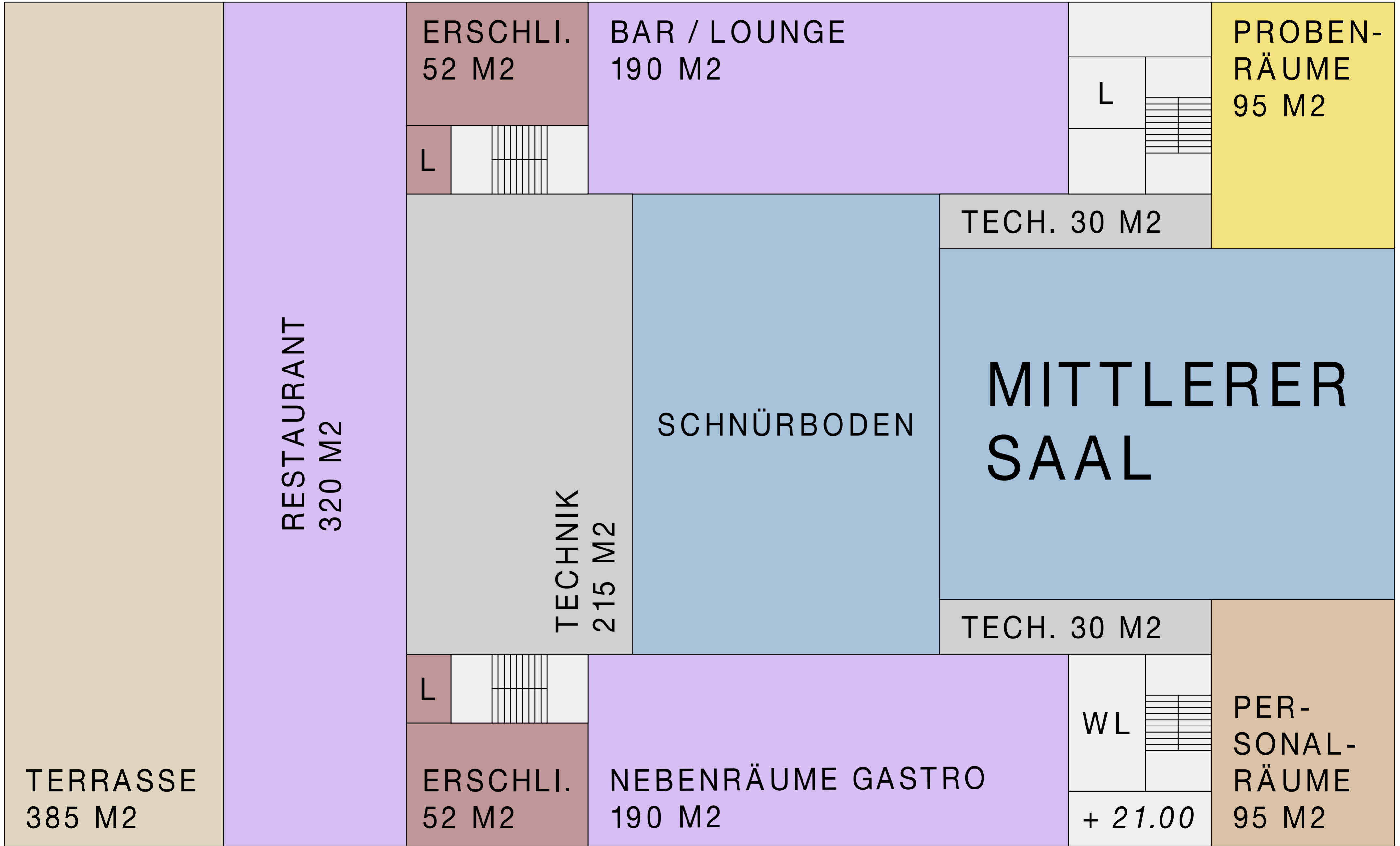

SCHNIEPER ARCHITEKTEN

15. APRIL 2022



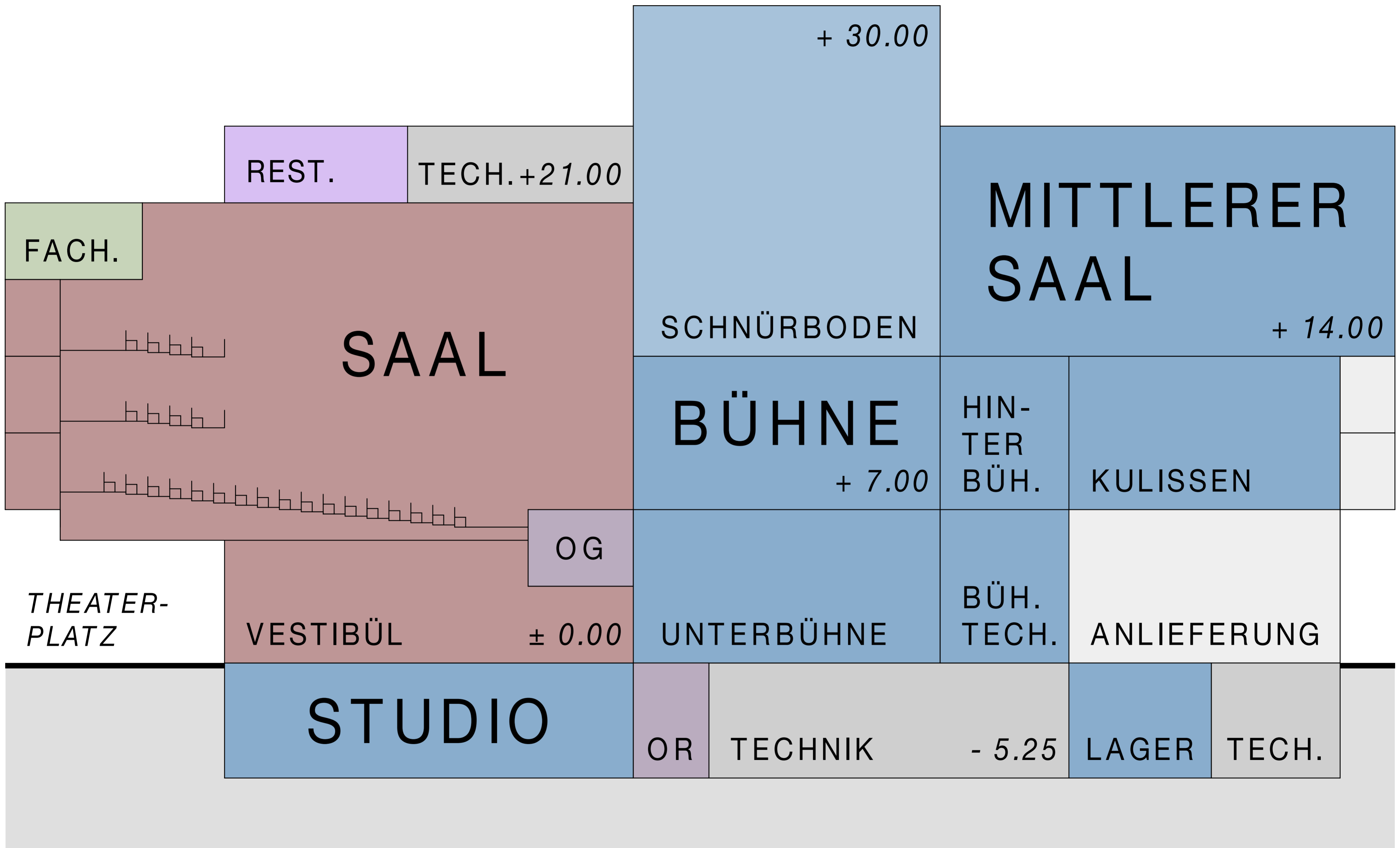

SCHNIEPER ARCHITEKTEN

15. APRIL 2022



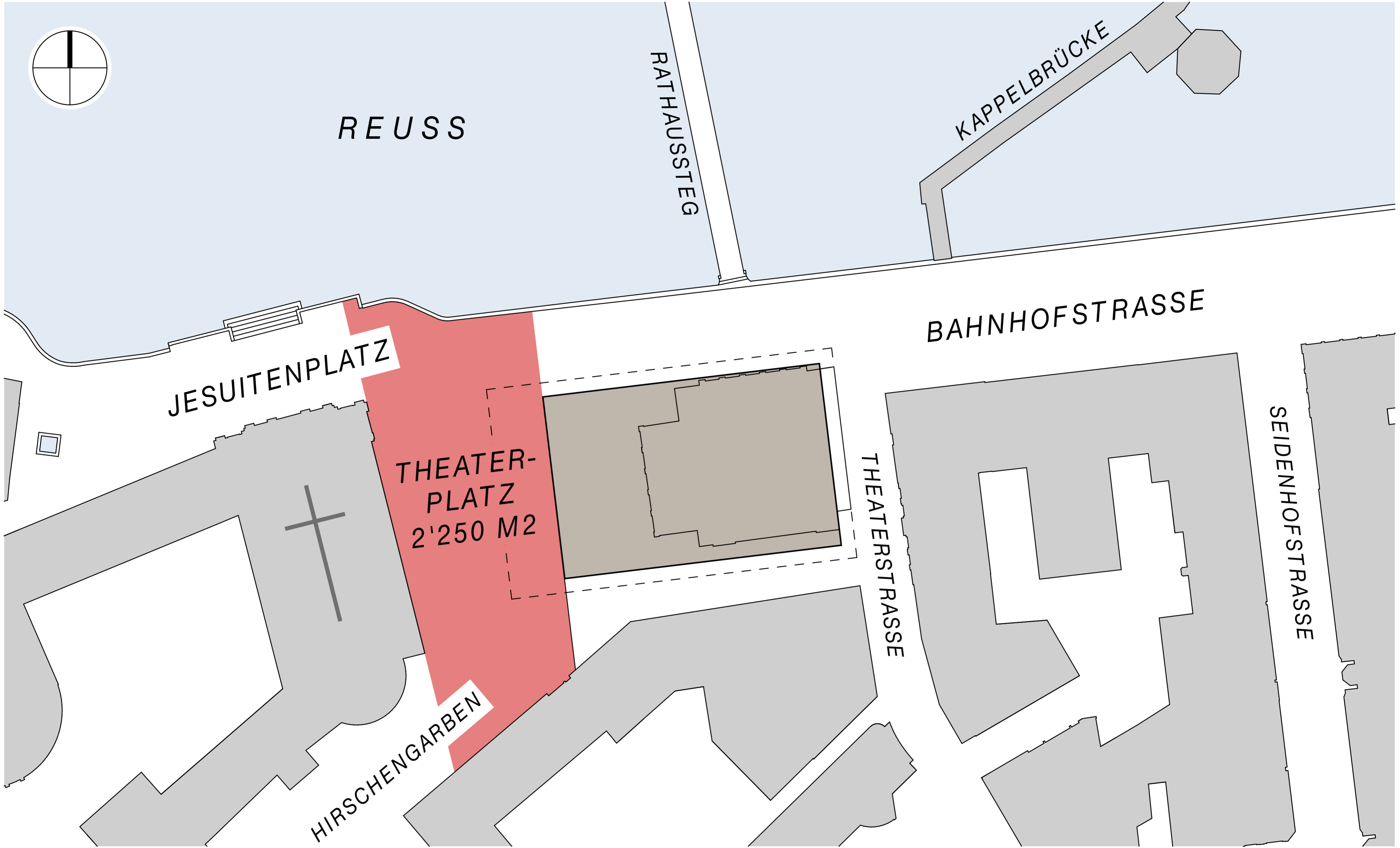

SCHNIEPER ARCHITEKTEN

15. APRIL 2022